

# MDTA Series

## Flat Wire Molded Inductor

### Size 6060



#### FEATURES

- Flat wire coil for low copper losses
- 
- 
- High current capacity
- AE
- 
- 

#### APPLICATION

- Noise suppressor for motor wipers / power seats/
- 
- 

#### Dimensions: [mm]

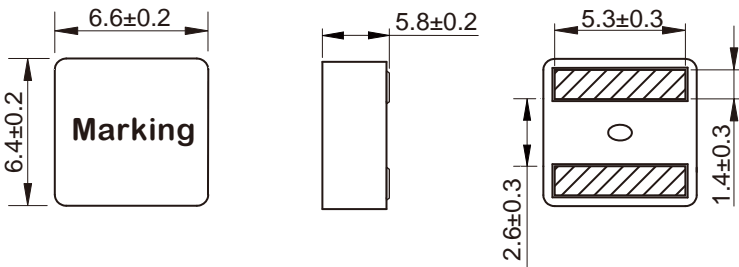

#### Land Pattern: [mm]

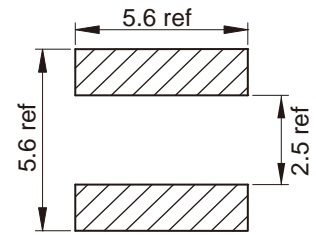

#### Electrical Properties:

	L (μH)	±20%	I (A)	(A)		R (mΩ)
		±20%				
		±20%				
		±20%				
		±20%				
		±20%				
		±20%				
		±20%				
		±20%				
		±20%				
MDTA6060-220M	22	±20%				

Saturation Current will cause L to drop approximately 30%  
 Temperature Rise Current that causes the specified temperature rise from 25°C ambient.

## Soldering Reflow:

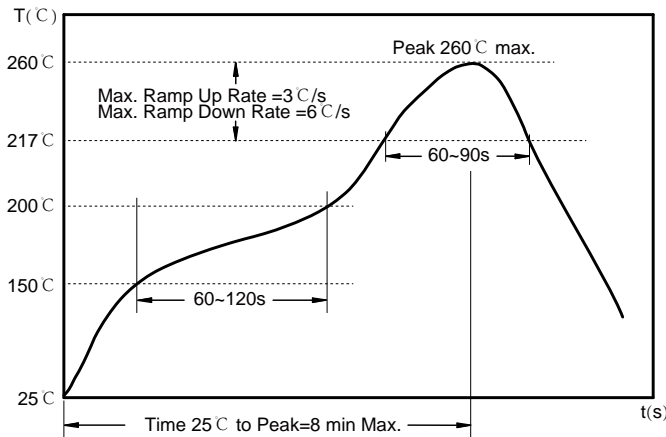

Preheat condition: 150 ~200°C / 60~120 sec.

Allowed time above 217°C : 60~90 sec.

Max temperature: 260°C .

Max time at max temperature: 10 sec.

Allowed Reflow time: 2x max.

## Packaging Information:

### Tape Dimension :

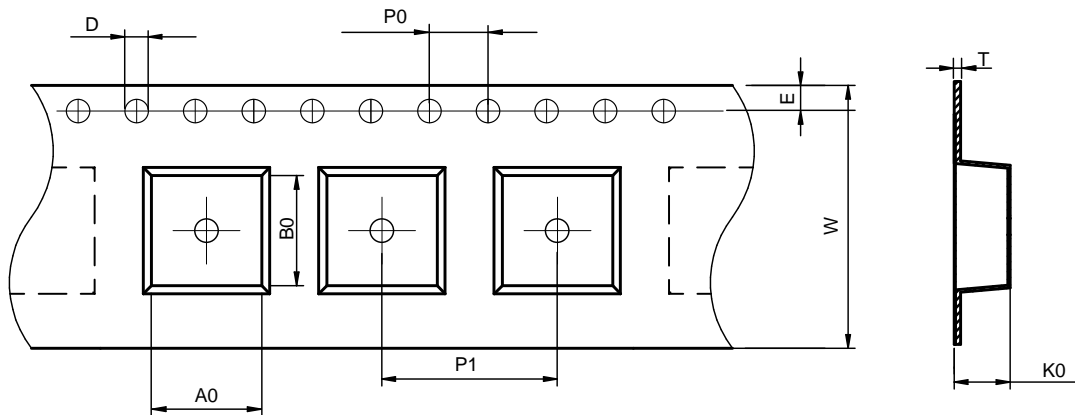

Series	A0 (mm)	B0 (mm)	D (mm)	P0 (mm)	P1 (mm)	W (mm)	K0 (mm)	E (mm)	T (mm)
MDTA6060	7.0± 0.1	6.8± 0.1	1.5± 0.1	4.0± 0.1	12.0± 0.1	16.0± 0.3	6.3± 0.1	1.75± 0.1	0.50± 0.05

### Peel force of top cover tape:

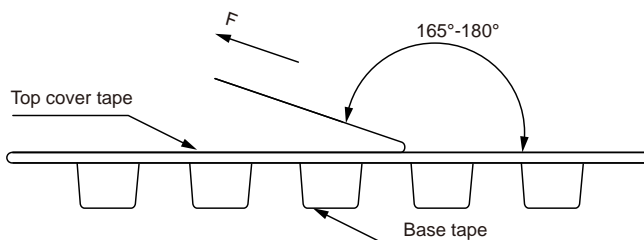

The peel force of top cover tape shall be between 0.1 to 1.3 N

### Product Marking:

Marking	Printing Inductance)
---------	----------------------

Reel Dimension: [mm]

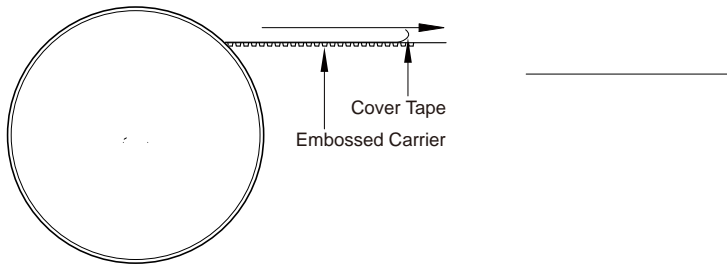

Packaging Quantity: